

26866/73/2000
 Planning Permit No. **APPROVED**
 SUBJECT TO THE CONDITIONS IN THIS OFFICE LETTER
 No. B1/2289/2000, 20.4.2000
 FOR MEMBER SECRETARY
 CHENNAI METROPOLITAN
 DEVELOPMENT AUTHORITY
 CHENNAI - 600 008.

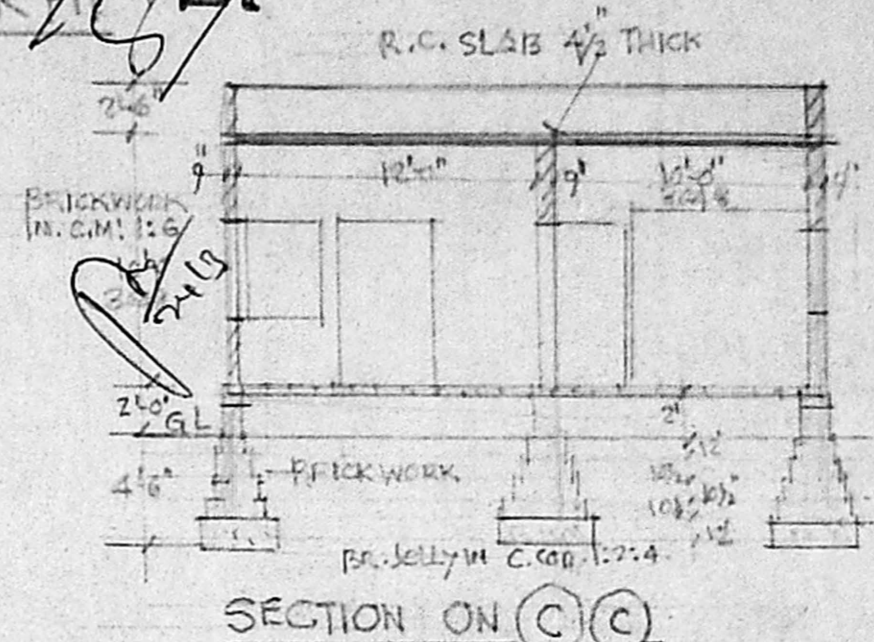
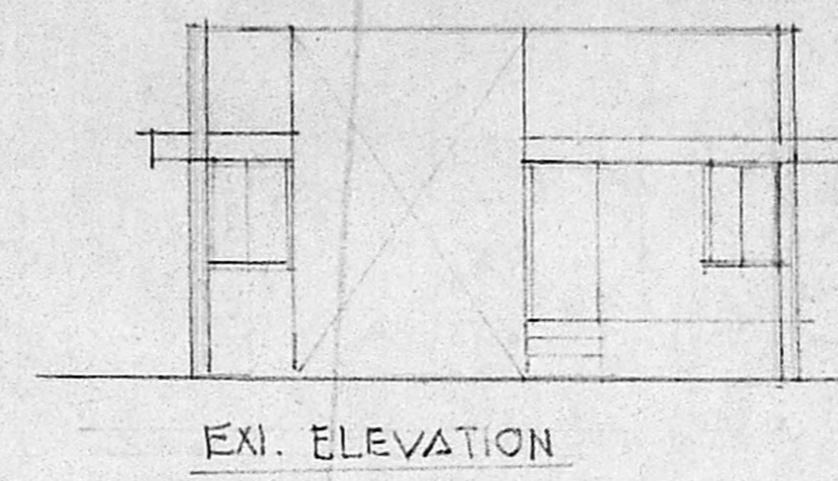
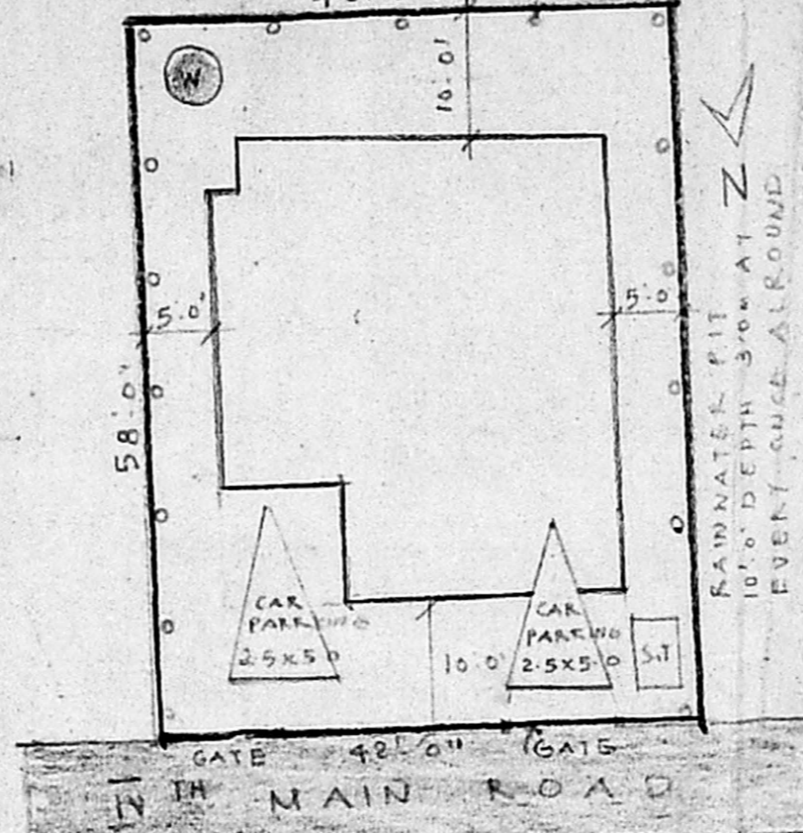
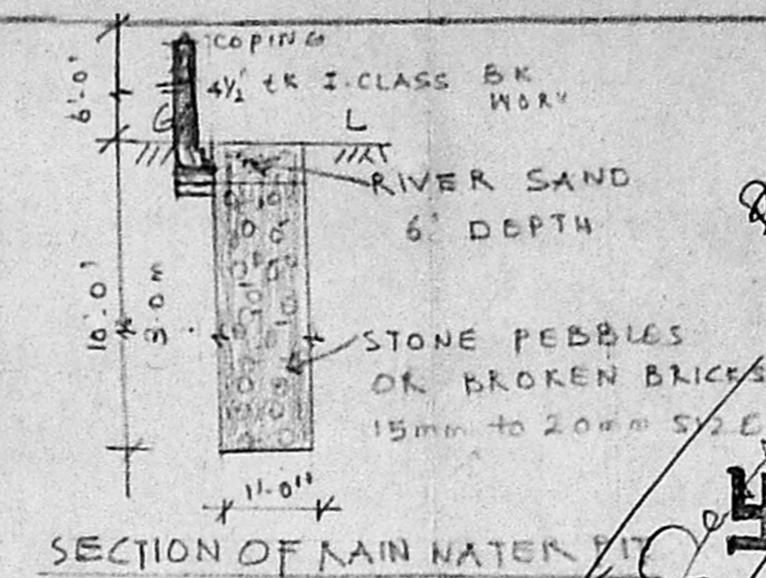
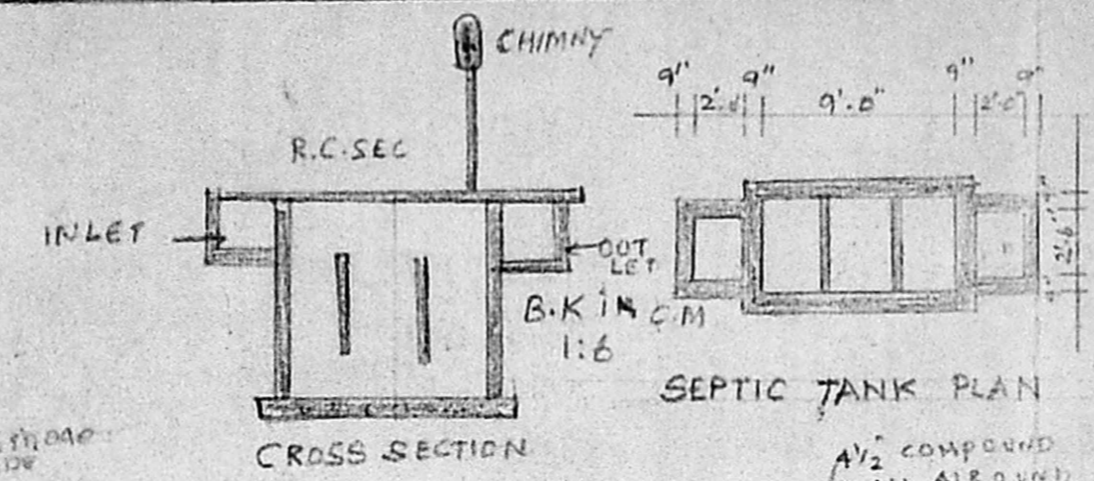
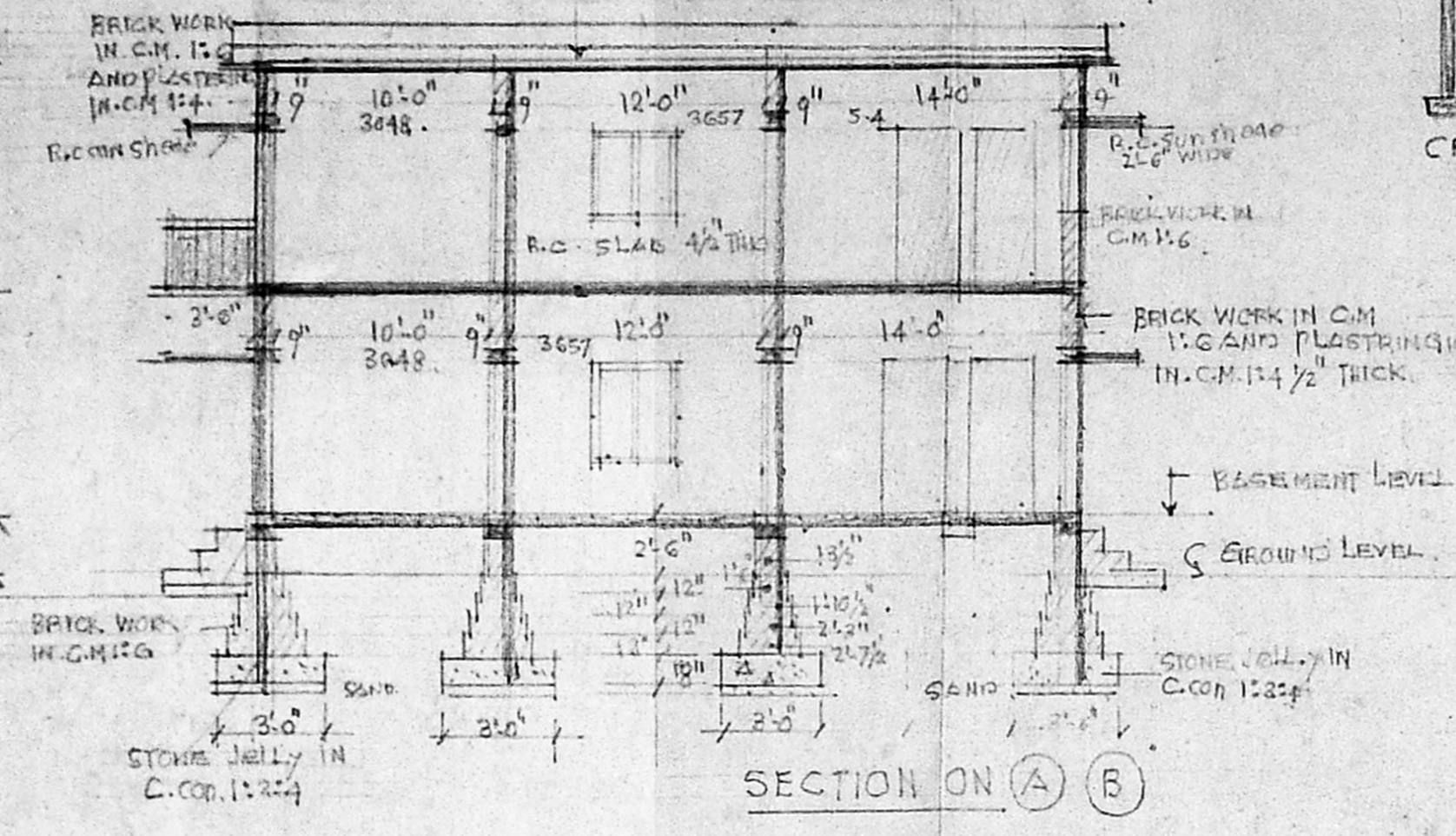

JOINERY-DETAILS

D DOOR	3'-6" x 6'-6"
D1 DOOR	3'-0" x 6'-6"
D2 DOOR	2'-6" x 6'-6"
W WINDOW	5'-0" x 4'-6"
W2 WINDOW	4'-0" x 4'-6"
W3 WINDOW	3'-0" x 4'-6"
V VEN	3'-0" x 2'-0"

NOTE

EXI. BUILDING TO BE DEMOLISHED	
GROUND AREA	2425 SQ. FT.
BUILDING AREA	568.59 SQ. FT.

COLOUR INDEX

PROPOSED CONSTR.	---
ROADS	---
PLOT, BOUNDARY	---

JOINERIES

D = TEAK WOOD DOOR	= 3'-6" x 7'-0"
D1 = DOOR	= 3'-0" x 7'-0"
D2 = DOOR	= 2'-6" x 6'-6"
W = TEAK WOOD WINDOW	= 5'-0" x 4'-6"
W1 = GLAZED WINDOW	= 4'-0" x 4'-6"
W2 = WINDOW	= 3'-0" x 4'-6"
W3 = WINDOW	= 3'-0" x 4'-6"
V = VENTILATOR	= 3'-0" x 2'-0"

GROUND AREA	2426 SQ. FT. 225.28 SQ. M.
GROUND FLOOR AREA	1054 SQ. FT. 100.74 SQ. M.
FIRST FLOOR AREA	919 SQ. FT. 85.40 SQ. M.
PLOT COVERAGE	44.68%
F.S.I	0.83

PLAN SHOWING THE EXISTING BUILDING TO BE DEMOLISHED AND RECONSTRUCTION PROPOSED BUILDING IN PLOT NO 22, S.NO 252/7A DOOR NO 2/220 WITH MAIN ROAD AT NATESAN COLONY KOTTAKAM VILLAGE TAMBARAM TALUK KANCHI DIST. SCALE 1" = 80" APPROVED MDP/DTP NO 7/24

P. GOVINDARAJU	JOB NO. 64/99
BUILDING DESIGNER	DRAWING NO. 64
NO. 1 TIPPY STREET	DRAWN BY P. S. RAJU
REGISTERED IN NO. CRAS-14	SCALE 1 1/2" = 16"
	DATE 27-10-99

K. SELVAM, B.E. AMIE, C. Eng (I) A.I.C.E.
 Consulting Civil Engineer Chartered Engineer
 Approved Valuer, Licensed Surveyor,
 Class - I, Reg. No. 319/99 2000
 Corporation of Chennai
 No. 169, Mogappair East,
 CHENNAI - 600 050.
 Ph 6248264

N. Venkateswarar
 (N. VENKATESWARAR)
 OWNER
 LICENSED SURVEYOR

